

COLLECTIVE CONCEPT

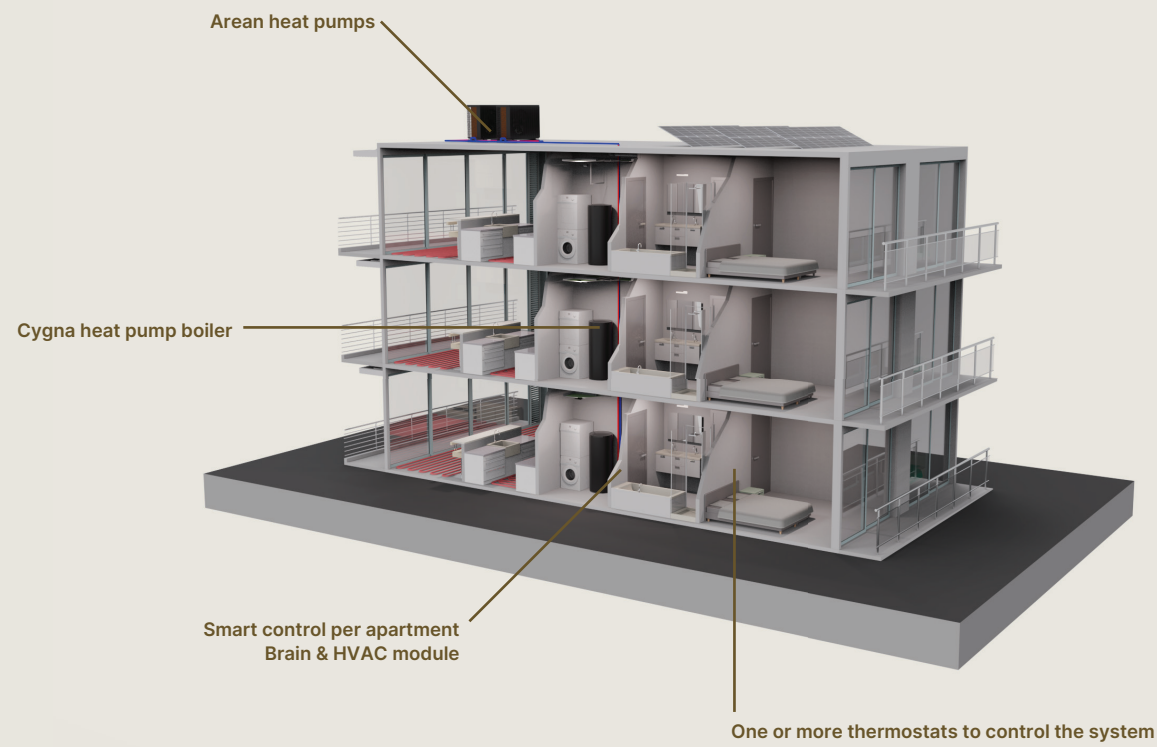

Renson heat pumps make it easy to improve the sustainability of both new and existing apartment buildings.

Multiple air/water or water/water heat pumps are installed in a collective setup, ensuring continuous capacity, even if one unit fails. In this collective setup, the heat pumps provide heating and cooling via a central circuit. The water in the central circuit heats the flats in winter and cools them in summer. Each apartment contains a heat pump boiler, which extracts heat from the central circuit to produce domestic hot water. The Brain and HVAC modules enable smart, cloud-connected control

The advantages of Renson's collective solution:

- Flexible source: Air/water, water/water heat pumps or a combination
- Heat pump boiler in every flat: reliable and energy-efficient
- Smart two-pipe system: 40% lower installation cost, lower energy cost and no technical space required thanks to patented software
- Optional upsell per apartment: ventilation, sun protection and lighting
- Fully online-supported:
 - Renson One app for residents
 - Installer Portal for installers
 - Remote consumption data for HOA/ESCO/property managers

DIGITAL SUITE

Tools that allow you to work faster, smarter and easier

INSTALLER APP

Your digital assistant for smart installation
Starting up and adjusting settings has never been quicker or easier. On site, the Renson Installer app guides you through the commissioning process step by step.

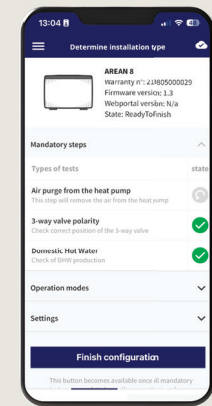

INSTALLER PORTAL

Your digital right hand at the office
The Renson Installer Portal allows you to manage all your installations: from project info, configuration, error codes and monitoring to follow-up. Less paperwork and fewer trips = more time saved!

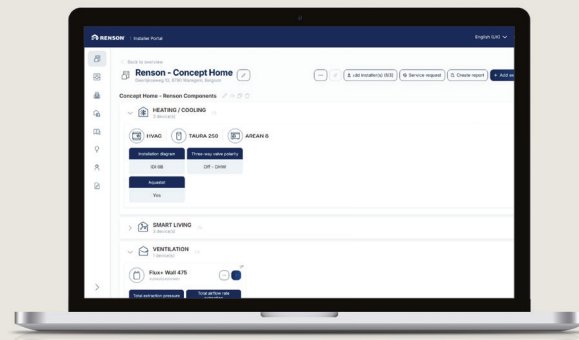

RENSON ONE APP

User app for easy control
Your customers also benefit from our digital solutions. With the Renson One app, residents can easily and remotely operate the entire system, giving them full control over their home's comfort. They also gain clear insight into their energy consumption and how the heat pump intelligently uses surplus solar energy.

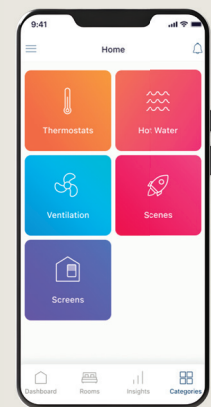

TECHNICAL ASSISTANCE

We're here to help
At Renson, service doesn't stop after delivery. We make sure that you, the installer, get to work smoothly, efficiently and with confidence:

- Free practical training: from the basics to commissioning, hands-on and directly applicable on site.
- Hotline support whenever you need it: +32 56 30 30 30



Call us on +32 56 30 30 30 and we'll be happy to assist you by phone.

LT111638 2023/07 0026 English

HEATING & COOLING

SMART, SUSTAINABLE AND ENERGY-EFFICIENT HEATING AND COOLING

A COMPLETE SOLUTION FOR EVERY PROJECT

Our solution consists of a limited number of components that can be combined modularly in all kinds of situations:

- for individual homes, as well as for apartment buildings with collective heating
- in new builds and renovations alike. In renovation projects, the heat pump can support or even replace a gas boiler when a low/medium temperature heating system is present and the property is adequately insulated.

INDIVIDUAL CONCEPT

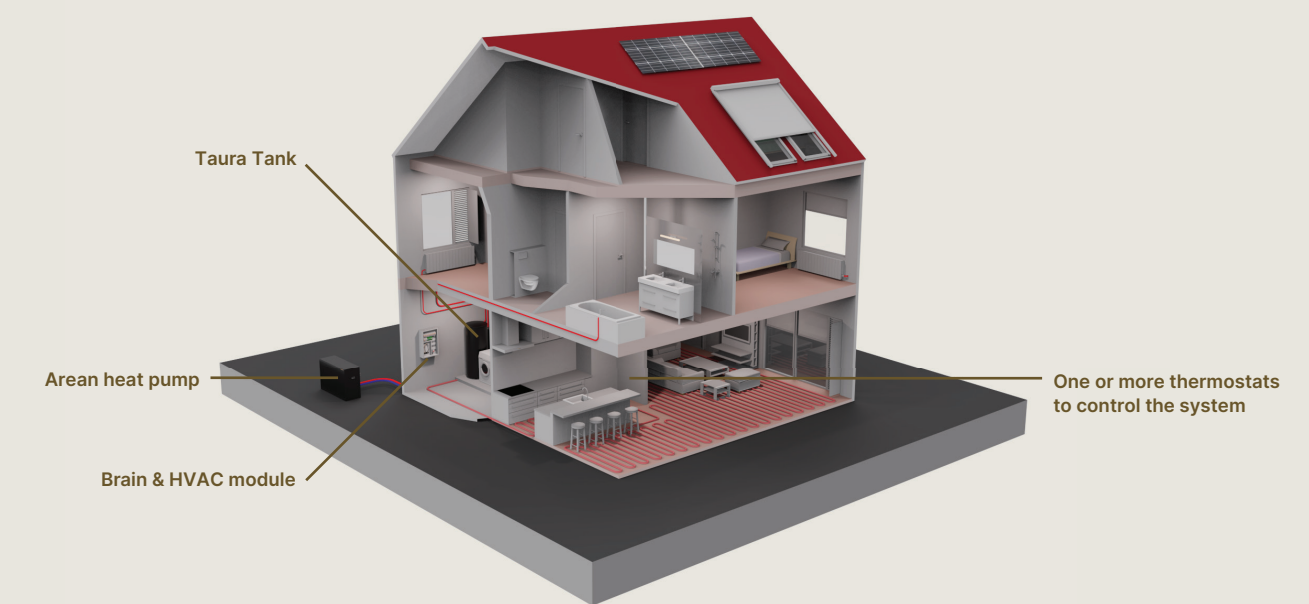

Renson heat pumps offer a sustainable and efficient solution for new builds and renovations alike. These highly efficient systems use energy from the outside air to provide comfortable heating, cooling and domestic hot water all year round. The air/water heat pump extracts heat from the outside air and transfers it to the home's water circuit. The system can control up to two different water temperature zones, making it easy to combine underfloor heating and convector radiators. For domestic hot water, the heat pump delivers temperatures up to 65 °C, stored efficiently in a 250-litre tank.

The advantages of Renson's individual situation:

- Various configurations available without indoor unit
 - Domestic hot water up to 65°C, without backup electric heater
 - Up to two different water temperature zones
 - Room zoning
 - Works with underfloor heating and/or convector radiators
- Standard connectivity
- Can be controlled using thermostats and the Renson One app
- Can be integrated with other technologies, including ventilation, sun protection and lighting
- Supported commissioning via the Installer app
- Remote support available via the Installer Portal



SUSTAINABLE HEATING & COOLING

Renson's heat pump solution offers a **sustainable and connected system for heating, cooling and domestic hot water** in both individual homes and collective projects. The combination of heat pumps, heat pump boilers, hot water tanks and smart controls creates an efficient solution tailored to any new build or renovation project. With digital tools and support available, installing and managing the system is easy and completely futureproof.



Why choose a Renson heat pump?

- **One partner** and one point of contact: from advice to service
- **Fast, simple commissioning:**
 - Easy commissioning for individual installations (via app)
 - Automated hydraulic balancing for collective installations
- **Full digital management:** live monitoring, remote settings and updates, consumption metering etc.
- **Flexible and scalable:** suitable for individual, cascade and hybrid projects
- **Reliable service:** from professional training to direct support, remotely and on site
- Technology meets **design:** an R290 product line with an eye for design

HEAT PUMPS



Arean air/water heat pumps for heating, cooling and hot water

- Heating – cooling – hot water
- Collective and individual projects
- New builds and renovations
- Monobloc with inverter technology
- Natural refrigerant (R290)
- Silent mode

Type	Arean* 8/1F	Arean* 15/1F	Arean* 15/3F	Arean* 22/3F
Outdoor unit	Monobloc			
Input/output	Air/water			
Capacity	8	15	15	22
Ecodesign (B0/W35)				
Energy label leaving water temp. 35 °C	A+++			
SCOP	5.0	4.9	4.92	4.91
Energy label leaving water temp. 55 °C	A++			
SCOP	3.71	3.78	3.78	3.7
Max. Heating capacity outside -7°C, leaving water temp. 35°C				
Heating capacity	5.8 kW	10.8 kW	10.7 kW	16.13 kW
Power consumption	2.31 kW	4.06 kW	4.06 kW	5.25 kW
COP	2.51	2.66	2.64	3.07
Max. Heating capacity outside 7°C, leaving water temp. 35°C				
Heating capacity	7.8 kW	14 kW	14.95 kW	22 kW
Power consumption	1.91 kW	3.85 kW	3.83 kW	5.32 kW
COP	4.08	3.64	3.88	4.13
Electrical specifications				
Phase	1 phase		3 phase	
Supply voltage	220 - 240 V		380~415 V	
Frequency	50 Hz			
General specifications				
Dimensions HxWxD (cm)	80×117×41	93×129×46	93×129×46	133×125×50
Weight (kg)	80	160	160	202
Sound pressure (1 m)	43 dB(A)	41 dB(A)	42 dB(A)	47 dB(A)
Refrigerant specifications				
Refrigerant	R290			
Refrigerant charge	0.5 kg	0.85 kg	0.85 kg	1.30 kg

Terrean water/water heat pump for heating and cooling

- Heating – standard passive cooling
- Collective projects
- New builds and renovations
- Monobloc with inverter technology
- Natural refrigerant (R290)

Type	Terrean 25S
Outdoor unit	Monobloc
Input/output	Brine/water or water/water
Capacity	25
Ecodesign (B0/W35)	
Max. heating capacity (EN14825)	25 kW
Energy label leaving water temp. 35°C	A+++
SCOP	4.8
Ecodesign (B0/W55)	
Max. heating capacity (EN14825)	23 kW
Energy label leaving water temp. 55°C	A+++
SCOP	3.8
Ecodesign (W10/W35)	
Max. heating capacity (EN14825)	32 kW
Energy label leaving water temp. 35°C	A+++
SCOP	6.3
Ecodesign (W10/W55)	
Max. heating capacity (EN14825)	29 kW
Energy label leaving water temp. 55°C	A+++
SCOP	4.9
Electrical specifications	
Phase	3 ph
Supply voltage	380-415V
Frequency	50 Hz
General specifications	
Dimensions HxWxD (cm)	101×65×70
Weight	163 kg
Refrigerant specifications	
Refrigerant	R290
Refrigerant charge	1,06 kg

Technical data sheets and item numbers:



DOMESTIC HOT WATER



Taura hot water tank

- For individual projects
- Capacity 250 litres
- Easy to install due to low weight
- Maintenance-free
- New builds and renovations

Type	Taura* 250
Volume	250 L hot water
Tank type	Duplex tank, maintenance-free
Water temperature	Up to 65 °C
Application	New builds and renovations
Ecodesign	
Energy label	B
General specifications	
Height	149 cm
Diameter	60 cm
Weight	56 kg
Tank material	Duplex



Cygna heat pump boiler

- For collective projects
- Water/water heat pump boiler
- Natural refrigerant (R290)
- Decentralised solution for domestic hot water
- Capacity 200 litres
- Free cooling: energy-efficient cooling in the flat by generating domestic hot water
- New builds and renovations

Type	Cygna* 200
Input/output	Water / Water
Volume	200 L
Ecodesign	
Energy label	A+
Sound power (Lwa)	48 dB(A)
Electrical specifications	
Phase	1 Ph
Supply voltage	230 V
Frequency	50 Hz
Power electric back-up	1500 W
General specifications	
Height	156 cm
Diameter	64 cm
Weight	98 kg
Maximum heat capacity	1650 W
Refrigerant specifications	
Refrigerant	R290
Refrigerant charge	0.15 kg
Domestic hot water specifications	
Max. water temp. without electric heater	62 °C
Max. water temp. with electric heater	75 °C

Technical data sheets and item numbers:



SMART CONTROLS

Renson Brain: the brains behind a healthy and comfortable home

- Central intelligence ensures smart heat pump control
- DIN rail modules in electrical cabinet
- Connected solution: accessible remotely
- Insight into total energy consumption through connection to digital meter
- Energy management for lower energy bills:
 - surplus solar energy can be activated for heating/cooling and domestic hot water
 - Heat pump can be used at low, dynamic energy tariffs
- The core system behind Renson One: other technologies can be connected and controlled using a single app
 - Individual control of heating/cooling in different rooms
 - Renson ventilation
 - Renson sun protection
 - Lighting

HVAC module

- Hydraulic intelligence
- Connection to pumps, three-way valves, motorised valves, temperature and pressure sensors

Easy control

Thermostat

- Temperature sensor
- White or black

Renson One app

- User app
- Can be used to control
 - Thermostat
 - Domestic hot water
 - Other connected technologies (ventilation, sun protection, lighting etc.)
- Can also be controlled remotely via smartphone

Technical data sheets and item numbers:

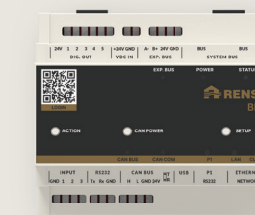

Renson Brain



HVAC



Thermostat



Renson One app

Functions	Thermostat	Mobile app
Room temperature adjustment	✓	✓
Domestic hot water temperature adjustment	-	✓
Heating/cooling activation	✓	✓
Control Renson One components	Temperature control	✓
Different modes	Auto (schedule), Away, Manual	