

ZIPSHADE® MINIMAL

Renovation IM 1

INSTALLATION INSTRUCTIONS

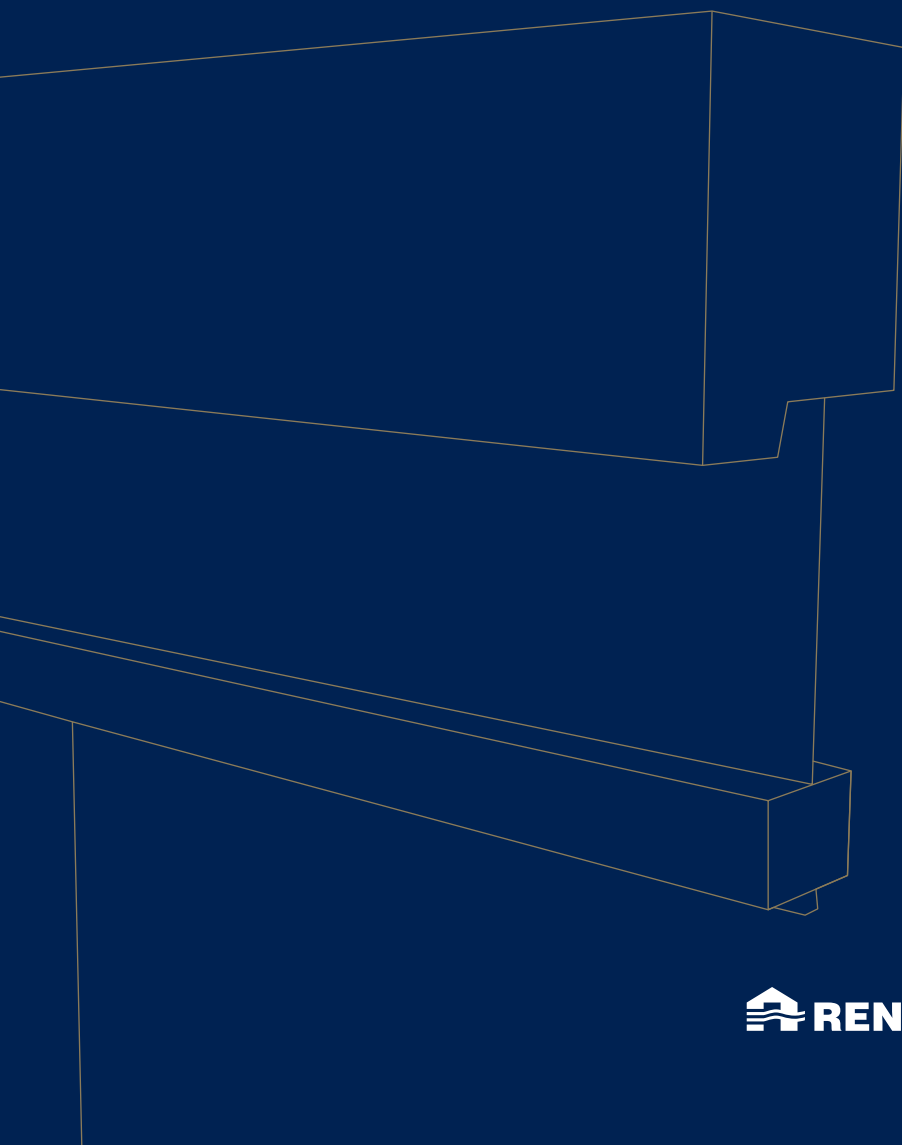

Table of contents

| | |
|--|----|
| 1 • General | 3 |
| 2 • Mounting situations..... | 3 |
| 3 • Installation..... | 4 |
| 3.1 • Dismantling the side guiding channels | 4 |
| 3.2 • Mounting the side guiding channels..... | 5 |
| 3.3 • Mounting the head box..... | 6 |
| 3.4 • Securing the head box to the side guiding channel | 9 |
| 3.5 • Snap-fitting the side guiding channels in place | 9 |
| 3.6 • Fixing the bottom bar..... | 11 |
| 4 • Electrical operation | 13 |
| 4.1 • Technical characteristics of the motors | 13 |
| 4.2 • Connection of the cable to the UV-resistant sheath (RR-F/RN-F) | 13 |
| 5 • Adjusting the endpoints of the motor | 14 |
| 5.1 • Somfy RTS motor | 14 |
| 6 • Final check..... | 15 |
| 7 • Maintenance | 16 |
| 8 • Disposal of the product..... | 17 |

NOTE

Please note that the indication in inches does not correspond exactly to the measurements in mm.

1 • General

! SAFETY

- Ensure adequate compliance with safety regulations during work on site:
- use hydraulic platforms or aerial work platforms instead of ladders
 - clearly mark off the area under/around the installation site
 - wear suitable safety clothing and safety shoes
 - accurate work is smoother, safer and ultimately faster

The Zipshade Minimal consists of:

- Head box M or L, including high quality screen, screen roller and motor
- One pair of side guiding channels for each single system
- One pair of side guiding channels and one coupling side guiding channel for each coupled system
- A separately supplied or assembled weighted bottom bar of your choice that guarantees the fabric is guided smoothly

2 • Mounting situations

There are a number of possible mounting situations:

Installation method 1

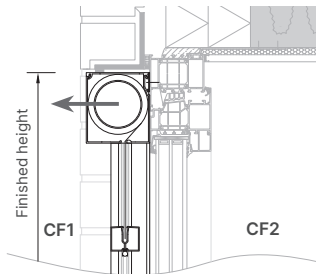

Surface-mounted, in front of the window, with fully finished head box

Installation method 1F

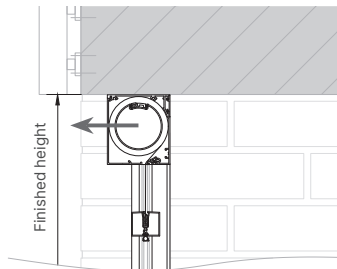

Freestanding installation without underlying structure

← Direction in which screen roller can be removed

3 • Installation

3.1 • Dismantling the side guiding channels

- Side guiding channel XS

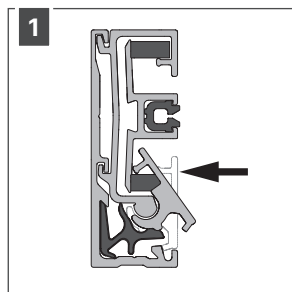

Snap open the closing profile of the side guiding channel.

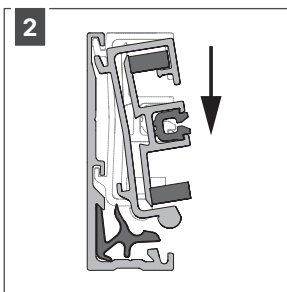

Now slide open the intermediate profile of the side guiding channel from the fixed profile. The dismantling of the side guiding channel is now complete.

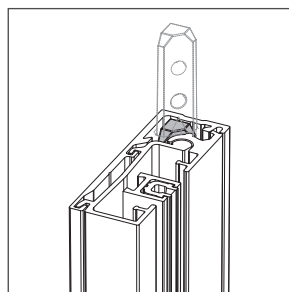

The mounting pin is already pre-mounted in the side guiding channel. It may remain there until the head box and side guiding channel are screwed together.

- Coupling side guiding channel C.40

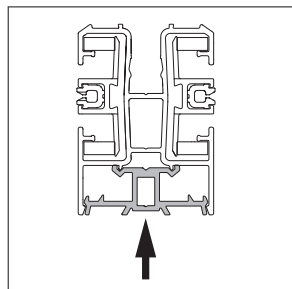

Snap the intermediate profile off the fixed profile of the coupling side guiding channel.

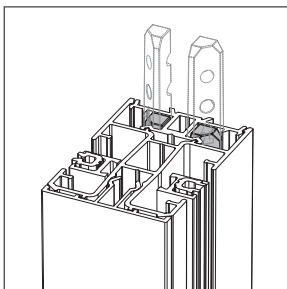

The mounting pins are already pre-mounted in the fixed profile. It may remain there until the head box and coupling side guiding channel are screwed together.

3.2 • Mounting the side guiding channels

! NOTE

It is important to install the fixed profile with great care so as to enable the further installation and smooth operation of the Zipshade Minimal.

• Side guiding channel XS

The fixed profile of the side guiding channel can be attached to the structure either laterally or via the rear wall. Please maintain a maximum distance of 18 inches between two attachment points.

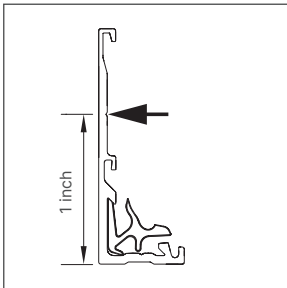

There is a 1 inch mark to facilitate lateral mounting.

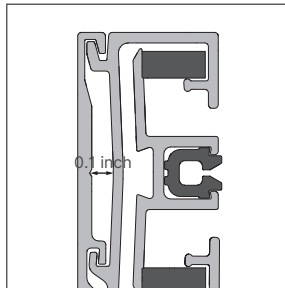

The head height of the screws should not exceed 0.1 inch; otherwise, the side guiding channel will not snap into place easily.

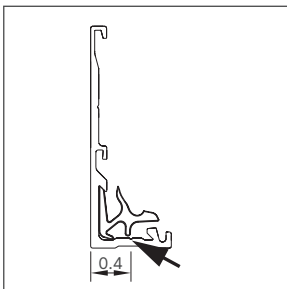

There is a 0.4 inches mark to facilitate mounting towards the rear wall.

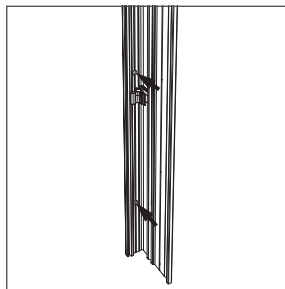

For mounting on the rear wall, one may also drill an optional hole with a \varnothing 0.2 inches bore. These are provided every 6 inches.

• **Coupling side guiding channel C.40**

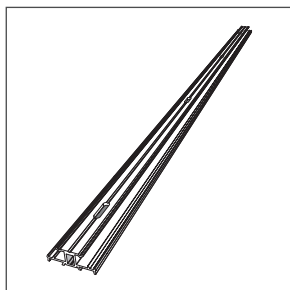

This coupling side guiding channel has pre-drilled slots (0.2 inches x 1 inch) at every 10 inches. Please maintain a maximum distance of 20 inches between two attachment points.

Please note that this profile is aligned with the underside of the head boxes. There is an opening of 0.15 inches on the bottom of this profile, which also contains the base plate located on the intermediate profile.



TIP

Check the correct placement of the side guiding channels: spirit level, mutual distance and squaredness, see 6. Final check, page 15.

3.3 • Mounting the head box

3.3.1 • Cable duct

You have chosen for one of following cable ducts, when ordering: B, F or H. Please do not forget to leave an extra space of 0.5 inches for the cable duct. The cable is flexible and can easily be laid in a loop.

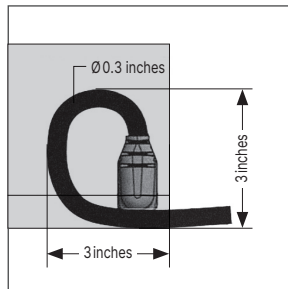
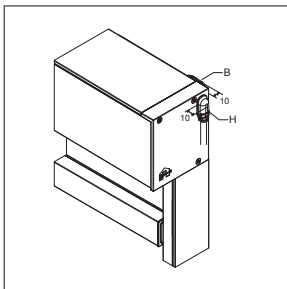
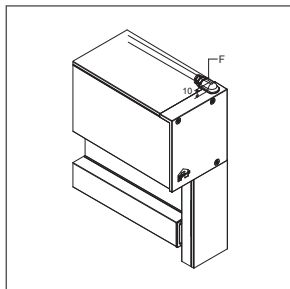

3.3.2 • Fastening the head box

The Medium head box must be secured to the rear structure starting from a system width > 142 inches.

The Large head box must be fixed to the rear structure at the sides of the head box. Additional fixation is required in the centre if the system width is > 142 inches.

This can be done in two ways:

- **By using the hook profile**

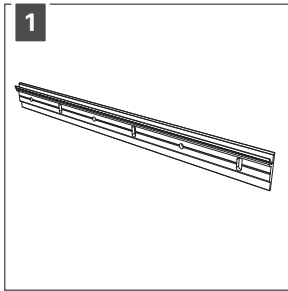

The hook profile has a length of 12 inches and can be attached to the underlying structure.

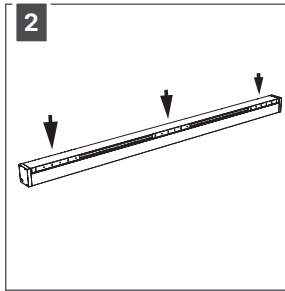

Three hook profiles are provided as standard.

- 1 to counteract the deflection of the head box profile in the middle.
- 2 for positioning on the sides of the head box.

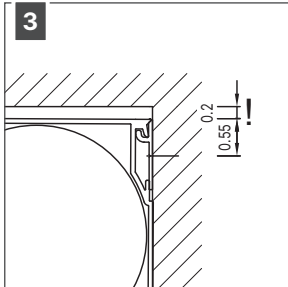

Position the hook profile so that there is enough space for the head box to be hooked up.

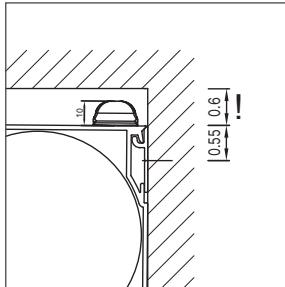

Also leave an extra 0.5 inches space in case you have opted for cable duct F.

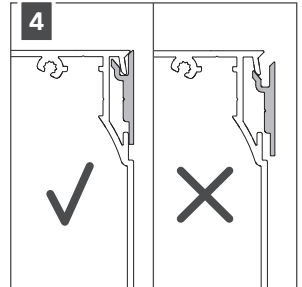

Make sure that the head box correctly hooks into the hook profile when you hang it inside.

- **By securing the head box profile directly to the structure behind it.**
The fabric roller tube package must first be dismantled, in order to do this.

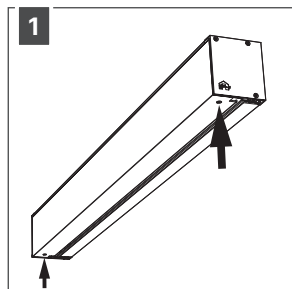

Open the head box using an Allen key 2.5, after which the head box profile can be clicked open.

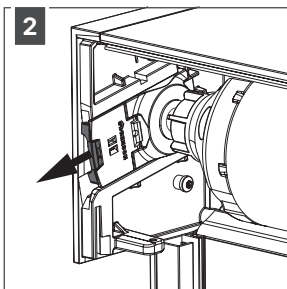

Pull on the blue plastic part in order to remove the fabric roller tube package.

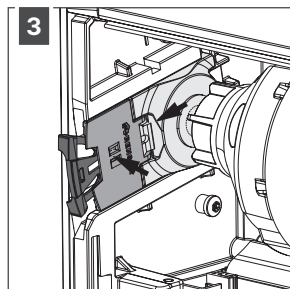

Now press the slide spring and remove the screen roller – without using screws.

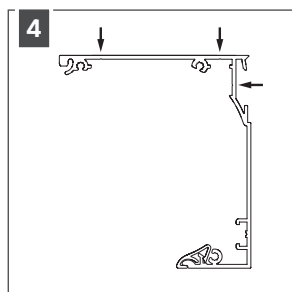

The head box can now be secured in place. Always do this along the provided drilling lines to ensure that the screen never touches the screw head. Provide fastening close to the side brackets as well as in the middle of the head box profile.

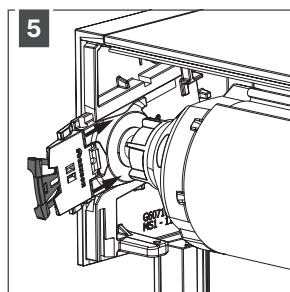

Now pull back the blue plastic part to slide the fabric roller tube package into the head box.

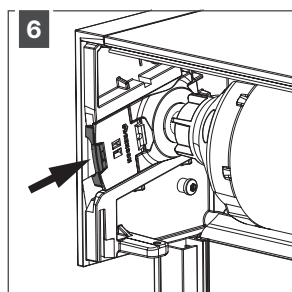

After you hear it snap, you can now slide the blue part under the spring.

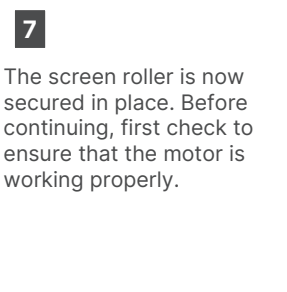

The screen roller is now secured in place. Before continuing, first check to ensure that the motor is working properly.

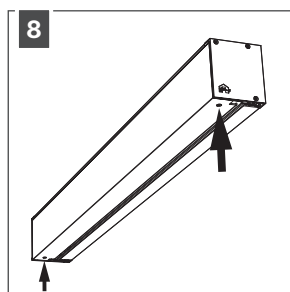

Snap on the head box profile and screw it in place with an Allen key 2.5.

3.4 • Securing the head box to the side guiding channel

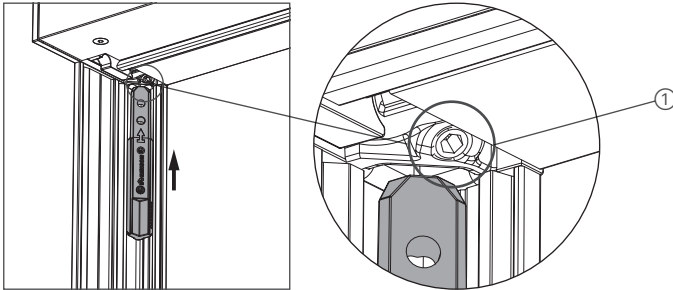

The head box is fixed on the side guiding channel with adjustable mounting pins. These are already pre-mounted in the side guiding channel. Unscrew the mounting pin with an Allen key 2.5, and slide the mounting pin into the head box until the arrow on the pin is fully concealed. Now retighten it and tighten the adjusting screw ① that is ready in the head box. The head box is now secured.

3.5 • Snap-fitting the side guiding channels in place

! ATTENTION

When snap-fitting the side guiding channels, take care not to damage the screen zip.

• Side guiding channel XS

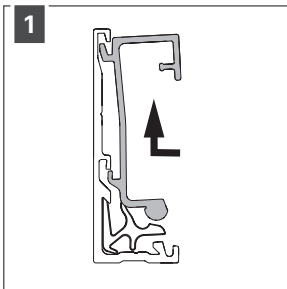

Slide the intermediate profile of the side guiding channel into the fixed drawing as shown in the drawing.

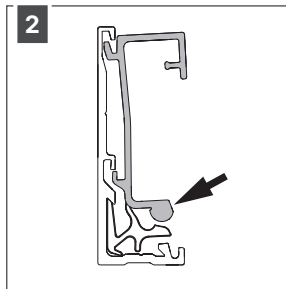

Then snap the intermediate profile into place by pushing at the position where the clips are visible.

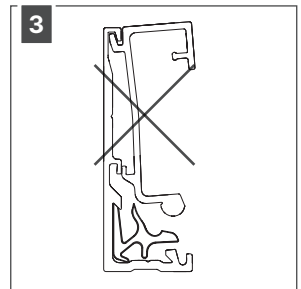

Check to ensure that the intermediate profile has correctly snap-fitted into place.

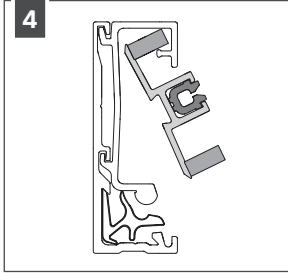

4 Turn the aluminium zip profile into the intermediate profile and ensure that the cellular rubber is correctly positioned.

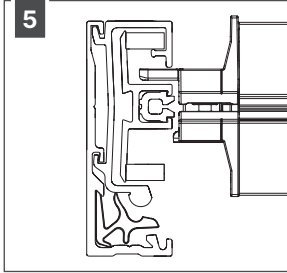

5 In case of a pre-assembled bottom bar, ensure the correct positioning of the bottom bar finger in relation to the aluminium zip profile.

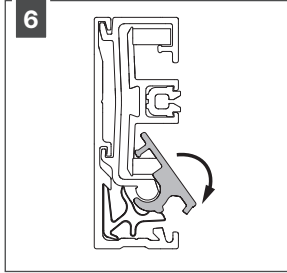

6 Now turn the locking profile into the side guiding channel and snap it shut. It is important to ensure that the cellular rubber remains straight during this operation.

• Coupling side guiding channel C.40

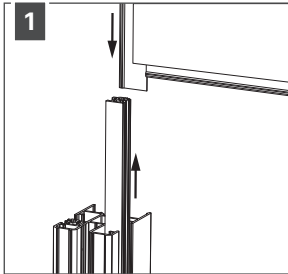

1 Slide both screen parts into the aluminium zip channel. It is easier to slide the zip out of the intermediate profile.

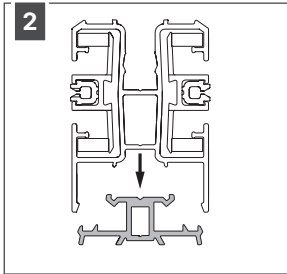

2 Securely snap the coupling side guiding channel on the fixed profile.

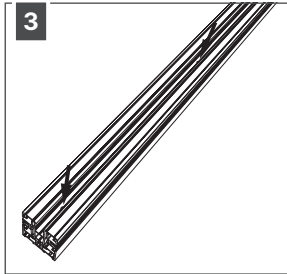

3 Then attach both profiles to each other. Screw holes are provided every 10 inches, be sure to fasten it every 20 inches. A sachet containing screws has been provided for each coupling side guiding channel.

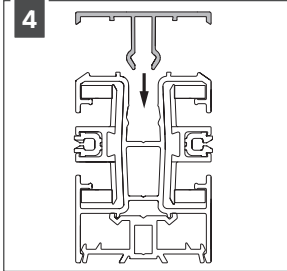

Now snap the removable profile onto the intermediate profile of the coupling side guiding channel.

3.6 • Fixing the bottom bar

If the bottom bar was supplied loose, it must be mounted on the screen.

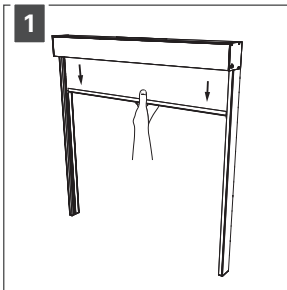

Connect the motor. Lower the screen to an easy working height.
Note! Guide the screen as it will not lower automatically since the bottom bar is absent.

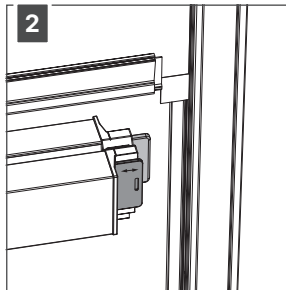

Hold the bottom bar correctly. The fixed bottom bar finger is located on the window side. The movable bottom bar finger therefore remains fully accessible.

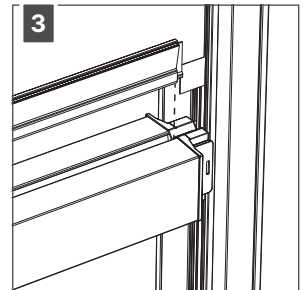

To snap the bottom bar on the screen, start on one side (left or right). Make sure that the clip profile starts against the plastic end cap at the start.

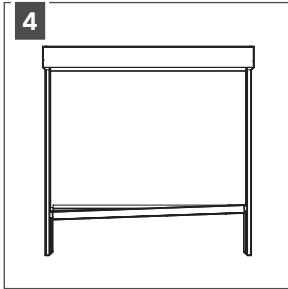

4 Push the clip profile into the bottom bar. While doing so, press the clip profile both behind and in front of the screen.

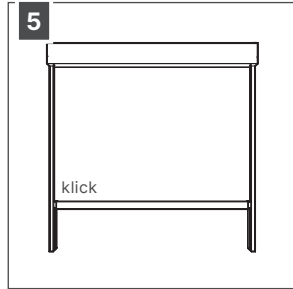
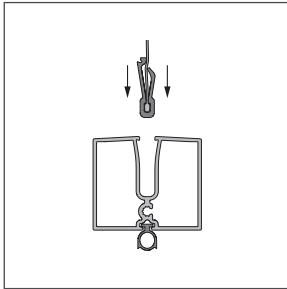

5 Now slide up from one side to the other.

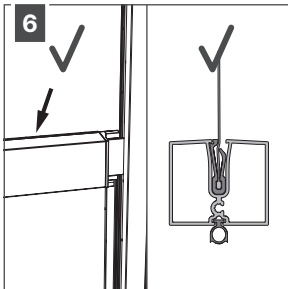

6 Make sure that the clips are correctly positioned in the bottom bar.

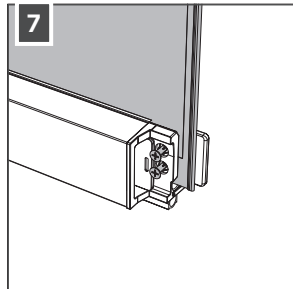
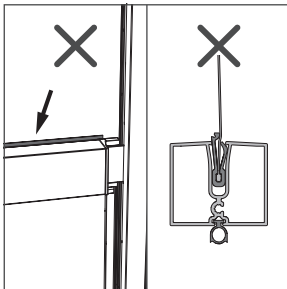

7 Position the screen correctly in the bottom bar plug. Make sure that the screen is positioned completely flat between the bar plugs.

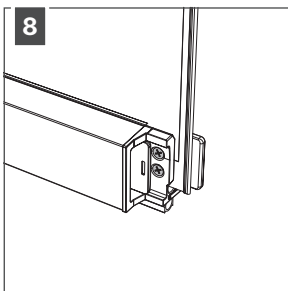

8 Screw the bar plug to the screen.

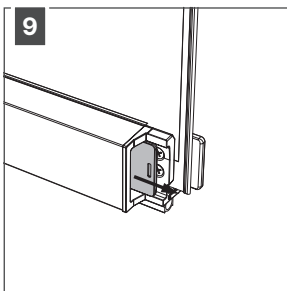

9 By pressing the lower bar plug finger, it will position itself in front of the screws.

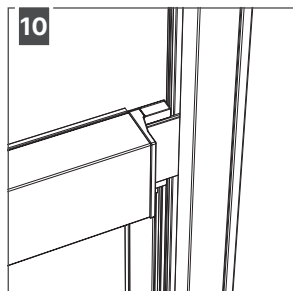

10 Now these are no longer visible and we ensure a correct positioning of the bottom bar in the side guiding channel at all times.

4 • Electrical operation

4.1 • Technical characteristics of the motors

| Parameter | Value |
|------------------|---------------|
| Voltage | 120V AC, 60Hz |
| Current | 2.1 A |
| Protection class | IP 44 |

4.2 • Connection of the cable to the UV-resistant sheath (RR-F/RN-F)

Type of power cable

RTS 120V AC / 6 Hz
3 conductor cable

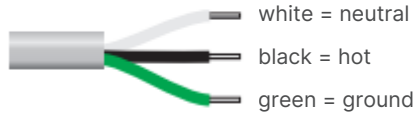

5 • Adjusting the endpoints of the motor

5.1 • Somfy RTS motor

ADJUST THE UPPER AND LOWER ENDPOINTS!

Upper and lower endpoints are set at the factory.

Setting the upper end point:

Upper end point is set at the factory, with the bottom bar connecting as closely as possible to the head box. Setting the upper end point for end use.

Setting the lower end point:

The lower end point is set to ± 16 inches from the bottom of the head box. Now set the lower end point with 0.5 inches of play (for the sealing strip) at the bottom of the screen.



TIP

If the electrical connection is only made after installing the sun protection, a temporary cable can be used to set the end points of the sun protection.

6 • Final check

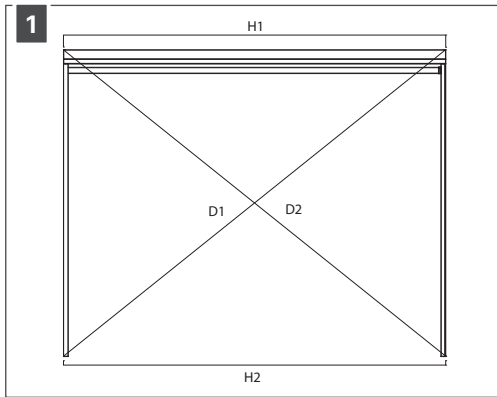

Before starting the motor: check whether the set-up is square. The diagonals (D1 and D2) and the parallels (H1 and H2) should be identical to the extent possible, in order to ensure the proper unrolling of the screen.

$$D1 = D2 \text{ and } H1 = H2$$

- 2** If the motor cable used is visible and installed outdoors, this cable must be provided with additional protection.
- 3** Check that the end points are set. If they are not adjusted, set the end points so that the motor automatically stops in the desired upper and lower position (see documents on motor settings).
- 4** Be sure to set the lower point up to 0.5 inches from the end of the side guiding channels so that the screen continues to remain tensioned.
- 5** Check that all screws, bolts and nuts are firmly tightened.
- 6** Roll the screen up and down several times to ensure proper operation.

7 • Maintenance (also see our warranty certificate*)

The product requires little maintenance, but in order to enjoy your product for many years, we do recommend the following:

- If the screen gets wet during an unexpected shower, you can easily roll up the screen and then, in better weather, unwind the screen to let it dry. Do not allow the screen to stay rolled up in a wet condition for more than three days so as to prevent mould and stains.
- Before cleaning, first remove loose dirt with a brush or vacuum cleaner. You can then use a cleaning product (avoid corrosive products) and remove the remaining dirt with lukewarm water. Always rinse the screen after cleaning. Do not clean in direct sunlight: quick-drying soapy water can leave stains on the screen.

Do not use abrasive products to clean.

- Dirty anodised or powder-coated profiles can be cleaned using lukewarm water and a gentle cleaning product. Never use corrosive or harsh products, abrasive sponges or other scouring products. We also advise against using high-pressure equipment.
- The hinges and moving parts should be lubricated at least once a year. A dry lubricant (TFE Flex Lube, ref. 1287) should be used for this purpose.
- Plastic sliding tubes can be lubricated with the dry lubricant (TFE Flex Lube, ref. 1287) after cleaning (removing twigs and leaves).
- Regularly check your product for twigs, leaves, birds' nests, etc. and remove them. Maintain this product with care.
- As the manufacturer, we recommend having a technical inspection carried out regularly by the installer, once each year in the case of non-residential construction and in the case of private sun protection.
- Always use original parts from the manufacturer.

Important to know:

- The electrical connection must be made by a qualified electrician, in accordance with applicable standards.
- Renson accepts no liability/warranty on the automatic operation of the screen motor, other than Somfy's applications.
- Renson cannot guarantee that the communication protocol for building automation and/or home automation shall be compatible with the screen motor.
- Due to the production process, small colour deviations may occur between colour samples and the profiles/screens of the sun screen. There may be small colour differences between components and profiles.
- The canvas may show slight colour nuances and minor imperfections.
- Waffle, herringbone patterns or crease formation on screens are possible and are not covered by the warranty!
- The colour of the sun screen may change slightly over time, depending on the chosen colours and designs.
- In screens where the screen moves down vertically due to the weight of the bottom bar or due to a tensioning system, wrinkles can form in the screen depending on the type of screen.

8 • Disposal of the product

Your screen can be fully recycled. Check with your local authority or nearest recycling station for local environmental regulations. Before dismantling the screen, turn off the power supply.

Materials must be separated when the product is destroyed. Combustible materials must be separated from non-combustible materials if the product is destroyed.

All photos shown are for illustrative purposes; the actual product may vary due to product placement.
Renson® reserves the right to make technical changes to the products described in this brochure.
The most recent product information, availability, and your local distributor can always be found on www.renson.eu

